

LABORHITS

Homogeniser T 25 digital ULTRA-TURRAX®

Features

- Digital speed display
- Electronic speed control
- Electronic overload protection
- Stainless steel dispersing elements can be cleaned quickly and easily
- Plastic disposable dispersing elements are available in two sizes
- Error code display
- Quiet operation

Wide Speed Range

Versatile Usable

PROMO CENA

1700,00€



LABORHITS

Homogeniser T 25 digital ULTRA-TURRAX®

Homogeniser

High-performance dispersing instrument for volumes from 1 to 2000 ml (H₂O) with digital speed display. It offers a wide speed range from 500 to 25000 rpm that enables users to work at high circumferential speeds even with small rotor diameters. A broad choice of dispersing elements adds versatility. Applications ranges from homogenizing waste water samples, use in laboratory reactors, dispersion tasks under vacuum / pressure and sample preparation in medical diagnostics.

Dispersing heads must be ordered separately.

Specifications

Motor rating input / output: 800 / 500 W
Working volume range (H₂O): 1 ... 2000 ml
Viscosity max.: 5000 mPas
Speed range: 3000 ... 25000 rpm
Speed display: LED
Speed control: stepless
Noise without element: 75 dB(A)
Extension arm diam. / length: 13 mm / 160 mm
Dimensions (W x D x H): 87 x 106 x 271 mm
Weight: 2.5 kg
Power supply: 200 - 400 V, 50/60 Hz
Protection class DIN EN 60529: IP 20



Type	PK	Cat. No.
T 25 digital ULTRA-TURRAX® with EU-plug	1	9.570 949
T 25 digital S2 ULTRA-TURRAX® with UK-plug	1	9.570 950
T 25 digital S3 ULTRA-TURRAX® with CH-plug	1	9.570 951

Dispersing heads

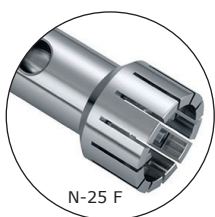

Plastic dispersing heads: Autoclavable.
 Stainless steel dispersing heads:
 Ultimate fineness: emulsions 1 µm to 10 µm and suspensions 5 µm to 50 µm, sterilisable by all methods. ST tools are recommended for use with tissue and other fibrous materials.



You can find more dispersing heads online.

Type	Diam. rotor/ stator mm	Max. immersion depth mm	Working volume ml	Material	PK	Cat. No.
S 25 D-14 G-KS	9.5 / 14	85	10 ... 500	PC, PEEK	12	9.570 861
S 25 N - 10 G	7.5 / 10	85	1 ... 100	PTFE, AISI 316L	1	9.571 207
S 25 N - 18 G	12.7 / 18	165	10 ... 1500	PTFE, AISI 316L	1	9.571 119
S 25 N - 25 G	17.0 / 25	165	50 ... 2000	PTFE, AISI 316L	1	9.571 200
S 25 N - 25 F	18.0 / 25	165	100 ... 2000	PTFE, AISI 316L	1	9.571 201
S 25 KV-18 G	12.7 / 18	225	10 ... 1500	FFPM / SIC, AISI 316L	1	9.571 117